

NOTES:
1. ALL DIMENSIONS FOR REFERENCE ONLY
2. REFER TO AIR LOGIC'S POLYSULFONE APPLICATION GUIDE
3. TUBE RETENTION PRESSURE SUBJECT TO TUBING DIMENSION AND STIFFNESS
4. GASES MUST BE CLEAN AND DRY

D

C

B

A

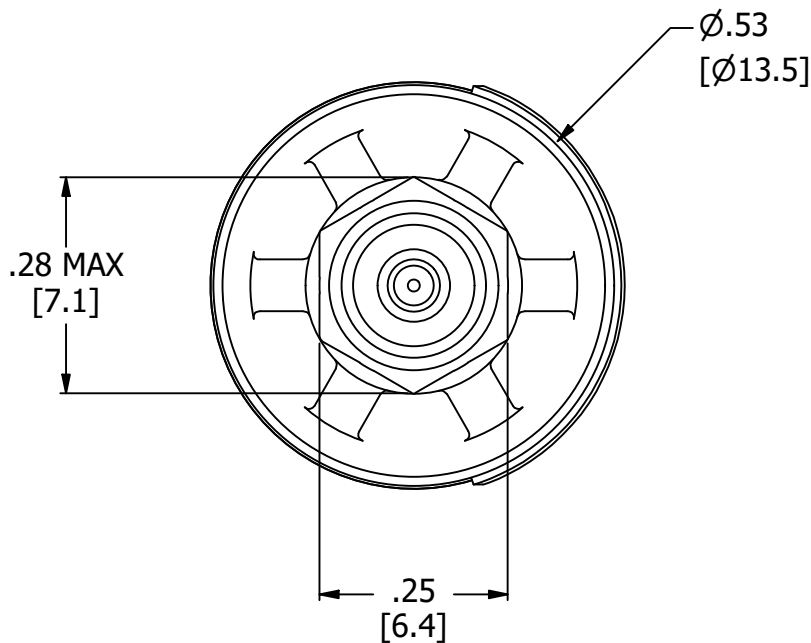

BARBED CONNECTIONS FOR .170 [4.3] I.D. TUBE,
FIRST BARB FREE OF PARTING LINE

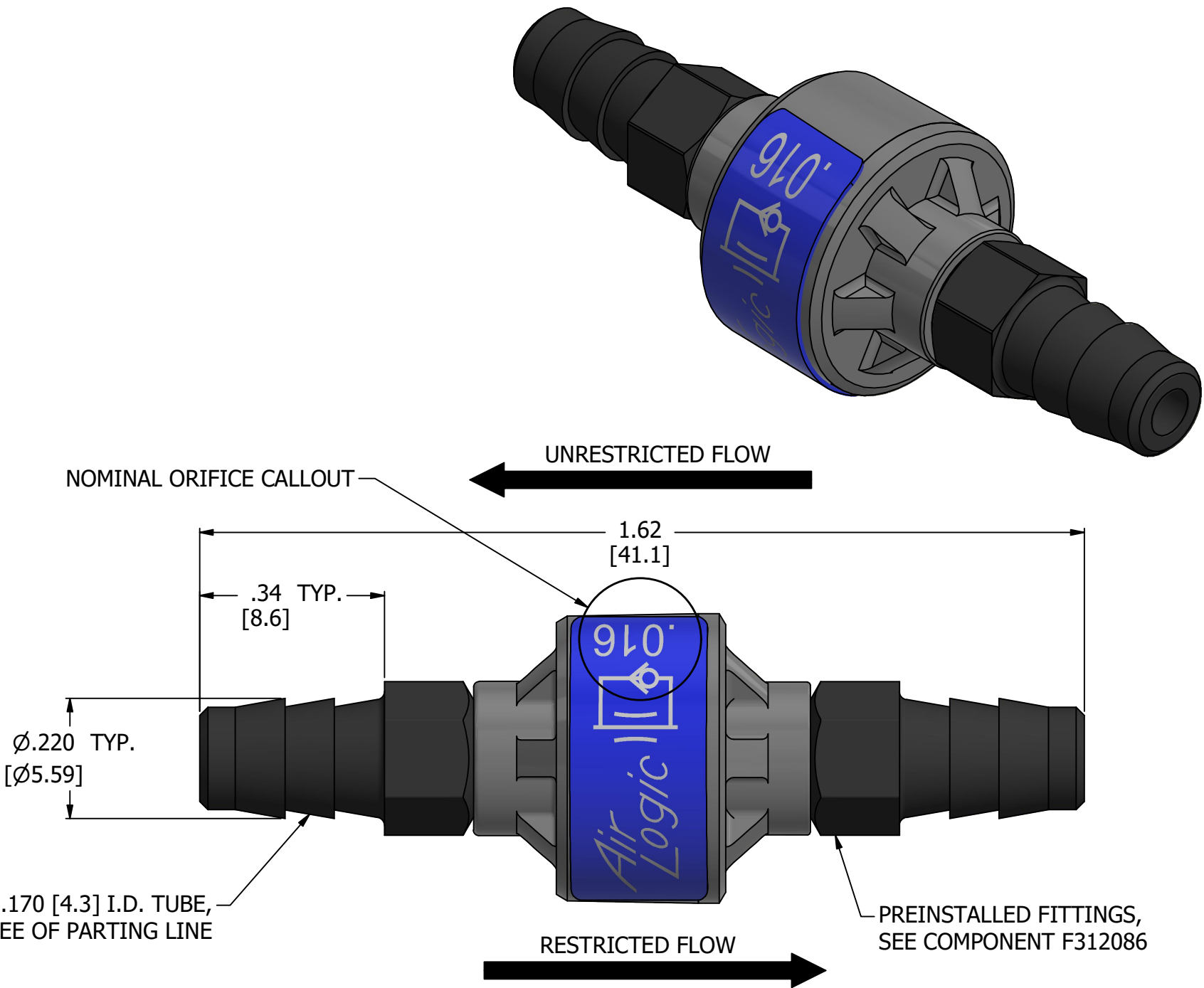

C

B

A

PRODUCT SPECIFICATIONS	
COLOR	GRAY, BLUE, BLACK
MEDIA	GASES, NOTE 2, NOTE 4
MAX INLET PRESSURE	75 PSI, [5.2 BAR]
TYPICAL TUBE RETENTION PRESSURE	125 PSI, [8.6 BAR], NOTE 3
NOMINAL ORIFICE SIZE	Ø.016, [Ø0.41]
WETTED MATERIALS	POLYSULFONE, SILICONE, NYLON
RECOMMENDED SYSTEM FILTRATION	5 MICRON

<div><div><div></div></div><div><div>AIR-LOGIC</div><div>® DIVISION OF KNAPP MFG, INC.</div><div>5102 DOUGLAS AVE RACINE, WI 53402</div><div>PHONE: (262) 639-9035 FAX: (262) 639-5996 WEB: AIR-LOGIC.COM</div></div></div>	
PART/DRAWING NO.: F2804404161B86	
DESCRIPTION: DIRECTIONAL FLOW CONTROL, Ø.016, Ø.170 BARB	
REVISION: A	DRAWN: 2/24/2021
SCALE: 4 : 1	SHEET SIZE: B

TERMS OF USE: THIS DRAWING IS FOR INFORMATIONAL PURPOSES ONLY. AIR LOGIC MAKES NO REPRESENTATIONS OF WARRANTIES CONCERNING SUITABILITY FOR ANY PARTICULAR PURPOSE. ALL PRODUCTS SUPPLIED ARE SUBJECT TO TERMS AND CONDITIONS FOUND AT AIR-LOGIC.COM
DRAWING TAKES PRECEDENCE OVER 3D MODEL GEOMETRY TOLERANCE: DECIMALS .00 ± .01, .000 ± .005, FRACTIONS ± 1/64 ANGLES 1/4° UNLESS OTHERWISE SPECIFIED UNITS: INCHES [MILLIMETERS]